

Suburbs

at THE HOLROYD

VENUE

SPECIFICATION

*PLEASE NOTE THAT WE ARE ALWAYS TRYING TO UPDATE
AND IMPROVE OUR VENUE! SO THIS INFORMATION IS LIABLE
TO CHANGE*

EQUIPMENT BACKLINE

LUDWIG DRUM KIT INCLUDING:

- KICK
- SNARE**
- X2 RACK TOMS (ONE NOT PICTURED)
- FLOOR TOM
- VARIOUS CRASHES AND HATS**
- X2 DRUM STOOLS



****WHILST WE CAN PROVIDE BREAKABLES, BANDS PLEASE BRING YOUR OWN IF POSSIBLE**

EQUIPMENT

BACKLINE

MARSHALL COMBO AMP (MG SERIES, 50DFX)



CARLSBRO VINTAGE REPLICA BASS COMBO
(COBRA MODEL)



EQUIPMENT

DJ RIG

M6 USB 4 CHANNEL MIXER

PIONEER XDJ

X2 TECHNICS QUARTZ DIRECT DRIVE TURNTABLE SYSTEM

VARIOUS WIRED / WIRELESS HEADPHONES ALSO AVAILABLE



THIS EQUIPMENT IS SITUATED AT THE DJ BOOTH ON THE FRONT SIDE OF THE STAGE - HOWEVER, THESE CAN BE BROUGHT CENTRE STAGE ONTO TABLES IF DESIRED

EQUIPMENT

SOUND

PA SYSTEM

DESK

ALLEN & HEATH QU24 MIXING DESK

SPEAKERS

X2 YAMAHA DXS18XLF ACTIVE 1600W 18" SUBWOOFER

X2 RCF SPEAKER

X 2 ALTO PROFESSIONAL TS110A ACTIVE PA SPEAKER

MONITORS

X3 ALTO PROFESSIONAL SXM112A TOURMAX MONITORS

X2 ELECTRO-VOICE ELX 112P MONITORS

X1 ALTO PROFESSIONAL TS SUB 18 TRUESONIC MONITOR

CONNECTION FROM PA TO DESK RUNS THROUGH:

ALLEN & HEATH AB168

DRIVERACK PA2

CHORD SB12:4:30 STAGEBOX (12 INPUTS)

IMG STAGELINE STAGEBOX (12 INPUTS)

EQUIPMENT

SOUND

MICS + MISC

MICS

X1 D112 MKII

X1 AKG P2

X3 AKG P4

X2 AKG P17

X5 SM58

X1 PG58

X4 58 REPLICAS

X3 SM57

X1 E835

X1 SCARLETT STUDIO

DI BOXES

X2 LD SYSTEMS LDI02 ACTIVE

X1 DJDI PASSIVE DBX

X1 ART ACCESSORIES ACTIVE X DIRECT

X2 BEHRINGER ULTRA DI

CABLES

X2 SHORT XLRS (<5M)

X16 MEDIUM XLRS (7-10M)

X3 LONG XLRS (12-16M)

X2 EXTRA LONG XLRS (>20M)

X21 VARIOUS JACKS

X2 XLR - JACK

X2 RAC TO STEREO JACK

X1 STEREO RAC

EQUIPMENT

LIGHTING

FOR INFO ON PLACEMENT, SEE FLOOR PLAN ON NEXT PAGE

X2 ADJ MEGA HEX PARS

X4 STAIRVILLE 240/8 RGB LED BARS

X2 CAMEO HYDRABEAM 4000

X2 GEAR4MUSIC SOL-30S

X2 LEDJ SLIMELINE 70

X2 VARYTEC HEROWASH 80

*WE ALSO HAVE A PROJECTOR THAT CAN BE CAST ONTO THE
BACK WALL OF THE STAGE*

REFERENCE PICS

AUDIENCE PERSPECTIVE



BACK OF STAGE / DRUMMER PERSPECTIVE



REFERENCE PICS

ON THE NIGHT



VON NOIRE PHOTOGRAPHY



ANDY WALKER



VENUE FAQ'S

AUDIENCE CAP?

WE ARE A 300 CAP VENUE - WE HAVE TWO LARGE TV SCREENS FURTHER BACK IN THE VENUE TO GIVE A CLOSE UP IMAGE OF THE STAGE ON BUSY SHOWS SO EVERYONE GETS TO SEE THE SHOW FROM ALL ANGLES!

PARKING?

WE HAVE A MEDIUM SIZED CARPARK AVAILABLE AT THE VENUE FOR BAND AND AUDIENCE USE

GREEN ROOM?

WE HAVE A GREEN ROOM AVAILABLE! WITH THE FOLLOWING:
TEA , COFFEE FRIDGE TABLES CHAIRS EN SUITE SHOWER AND TV

SOUND RESTRICTIONS

WE CAN OFFER SOUNDCHECK TIMINGS TO INDIVIDUAL NEEDS, PLEASE EMAIL FOR FURTHER DETAILS

HOWEVER, GENERALLY DURING THE WEEK WE BEGIN SOUNDCHECKS AT 6PM, WITH THE WEEKENDS BEING MORE LENIENT ON TIMINGS

CURFEWS ARE AS FOLLOWS:

SUNDAY - THURSDAY = 11PM

FRIDAY AND SATURDAY = LIVE MUSIC 12PM, DJ 1AM

FLOOR PLAN

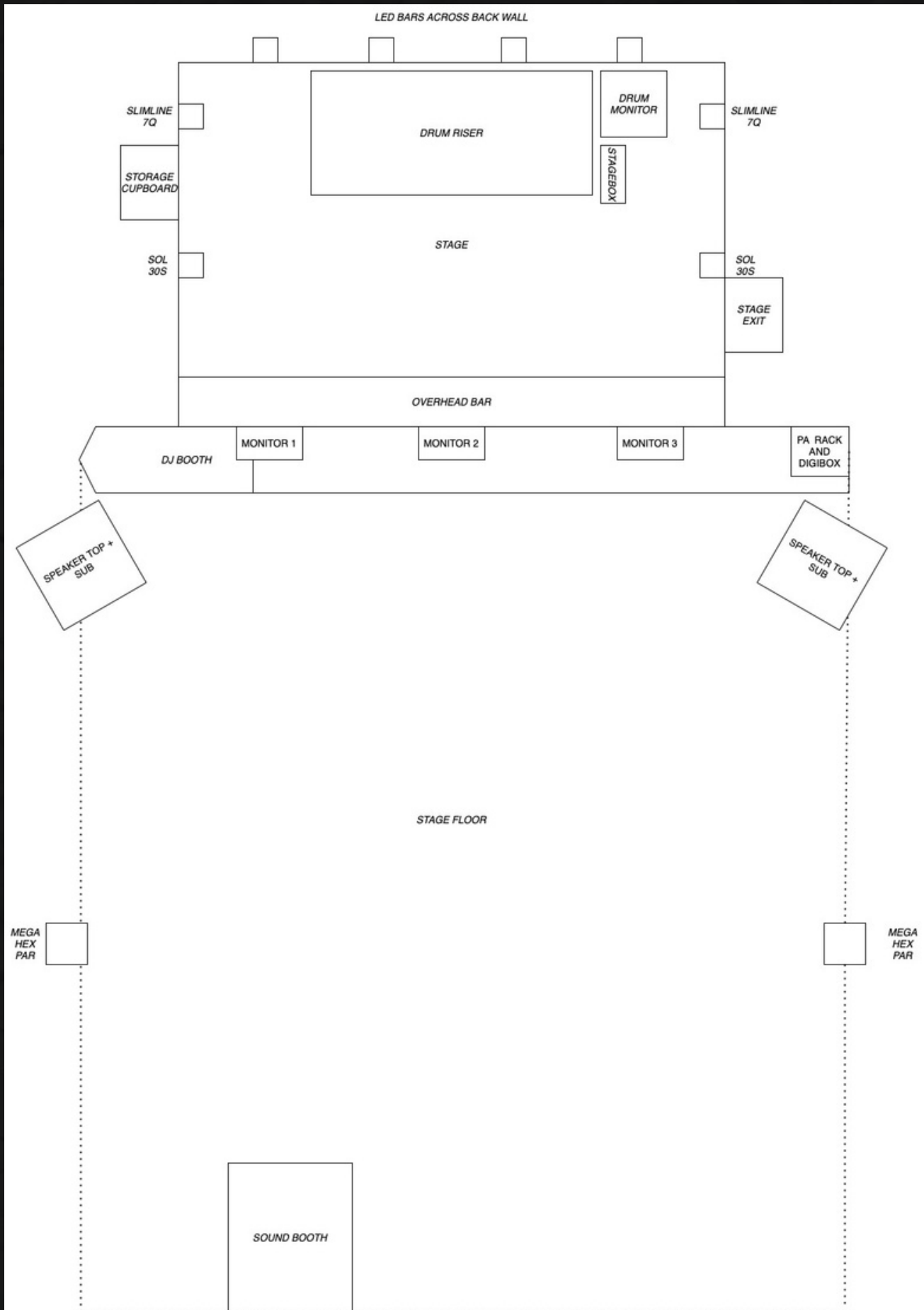

CONTACTS

ADDRESS

THE HOLROYD ARMS
ALDERSHOT ROAD
GUILDFORD
SURREY
GU2 8AF

EMAIL'S, NUMBERS AND SOCIALS

GIG REP / INFO - ANDREW HAMILTON

PHONE: 07948 624022

EMAIL: HILLSY66@GMAIL.COM

EMAIL: HOLROYD2019@GMAIL.COM

FOH / TECH ENQUIRES - SHANNON JAMES

PHONE: 07392442719

EMAIL: SHANNONJAMES.SOUND@GMAIL.COM

WEBSITE

THEHOLROYDARMS.COM

SOCIAL MEDIA!

INSTAGRAM: @SUBURBS.VENUE

FACEBOOK: @HOLROYDARMSVENUE

TIKTOK: @SUBURBS.VENUE